

FIRE DOOR LEAVES

Glass sliding fire doors

TECH SHEET: FD-09

Issue: 01-12-06

Automatic glass sliding fire door incorporating Pyropanel-Forster metal framing system, -/30/- FRL.

DESCRIPTION

Fully glazed automatic sliding fire door available as single or bi-parting configurations, incorporating the Pyropanel-Forster insulated steel framing system, Pilkington Pyrostop intumescent fire rated glass, and a Kaba fire rated door operator.

APPLICATIONS

Ideal for applications that require an automatic glass sliding fire door, but which also require the protection of a fully certified fire door. Especially suitable for in residential complexes, hospitals, schools, shopping centres, shops, offices, public buildings, luxury residential high rise developments, etc.

FEATURES

- Fully certified to Australian Standards.
- -/30/- FRL.
- Suitable for use in most wall types, including the Pyropanel -/60/- glass wall system which uses Pyropanel-Forster steel framing system and Pilkington Pyrodur fire rated glazing.
- 65mm x 70mm slim line profile.
- Extra large doors available.
- Incorporates 18mm Pilkington Pyrostop Fire rated glass with A-class impact resistance.
- Comes standard with intumescent perimeter smoke / fire seals.
- Single and bi-parting leaf configurations.
- Leaves weigh approx 55kg/m².
- Utilises the KABA Gilgen KGSSLMVSB door mechanism.

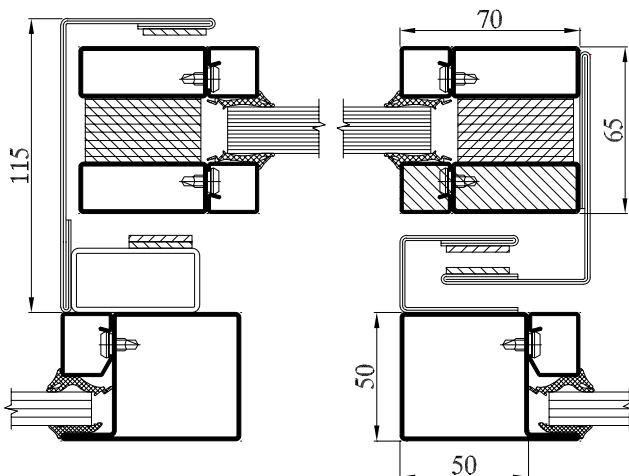

OPTIONAL EXTRAS

- Powder coating.
- Stainless steel frame.
- -/60/- or -/30/- surrounding side lites.
- Opaque film and decals to glass.

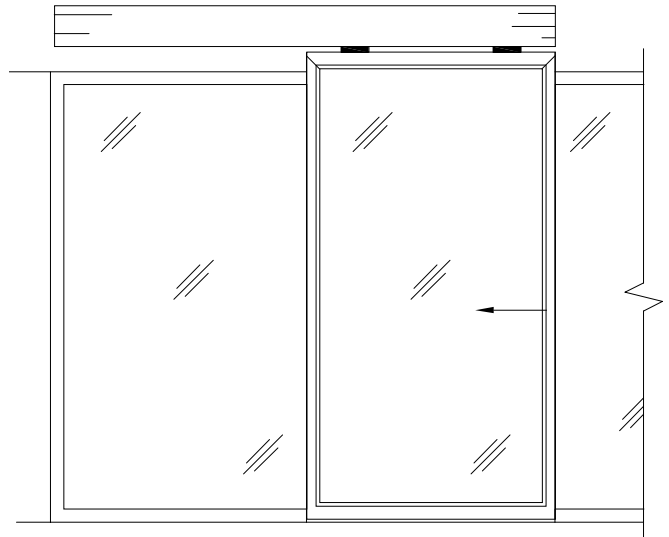

Typical layout of -/30/- single fire rated glass sliding door with -/60/- side lites

MODELS AVAILABLE

Model	FRL	Thick-ness	Max Leaf size - Single	Max Leaf size - Pair
PGSD30S	-/30/-	65mm	2700mm high x 1405mm wide	NA
PGSD30P	-/30/-	65mm	N/A	2700mm high x 1400mm / 1400mm wide

HOW TO SPECIFY

Eg, "Door to be a Pyropanel PGSD30S fully glazed single automatic glass sliding fire door, 65mm thick profile, -/30/- FRL, incorporating 18mm Pilkington Pyrostop fire rated glass, complete with flame guards, prime painted/ powdercoat / stainless steel* finish, incorporating a Kaba KGSSLMVSB certified fire rated operating mechanism, etc"

* denotes example - delete or change or specify as required

PYRO PANEL
Protecting Life & Property

Pyropanel Developments Pty Ltd
122-124 Beresford Rd, Lilydale, VIC, 3140
Ph: (03) 9735 5688 Fax: (03) 9739 5772
Email: sales@pyropanel.com.au
Web: www.pyropanel.com.au

Distributed by:
HOLLAND FIRE DOOR INSTALLATIONS
23 Saggart Field Rd, Minto, NSW, 2566
Ph:9603 8500 Fax:9603 9625