

# BULLET RESISTANT DOORS

## Special Purpose Bullet Resistant Doorsets

### DESCRIPTION

Pyropanel Bullet Resistant doorsets are tested to Australian Standards, to suit all applications. They have a nominal thickness of 50mm, and are supplied with a heavy duty steel door frame, factory-fitted ball bearing 100mm x 100mm butt hinges, or continuous piano hinges. All locksets and other door hardware are required to be factory-fitted to ensure no loss of integrity and to ensure correct positioning of steel plates within the door.

### APPLICATIONS

Pyropanel Bullet Resistant doorsets are suitable for a wide range of applications such as banks, embassies, prisons, cash rooms, apartment entry doors, etc.

### FEATURES

- Tested to AS/NZS 2343: 1997 achieving classifications of G0, G1, G2, R2, S0, and S1, as well as the AK47 urban assault rifle.
- Constructed with fire resistant materials (but not fire tested to AS 1530.4).

### OPTIONAL EXTRAS

- Smoke and acoustic seals.
- Bullet resistant vision panels.

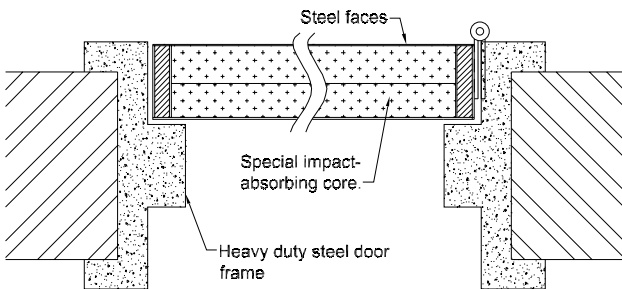

Illustration of typical doorset with frame solidly grouted into masonry wall. Special bullet resistant frames can be designed for stud wall applications.

### CLASSIFICATION TABLE (AS/NZS 2343:1997)

CLASS	WEAPON TYPE	CALIBRE	AMMUNITION	VELOCITY (m/s)
G0	Hand Gun	9mm	7.4g standard bullet	405 +/- 15
G1	Hand Gun	.357 Magnum	10.2g flat nose bullet	450 +/- 15
G2	Hand Gun	.44 Magnum	15.6g flat nose bullet	480 +/- 15
R2	Rifle	7.62mm	9.3g bullet	850 +/- 15
S0	Shotgun	12 gauge full choke	32g 70mm no.6 SG shot	400 +/- 15
S1	Shotgun	12 gauge full choke	24.8g 70mm single slug	450 +/- 15
AK-47	Urban Assault Rifle	7.62mm	8.3g jacketed bullet	715 +/- 15

### MODELS AVAILABLE

MODEL	BULLET RESISTANCE
BR-C	G0, G1, G2, R2, S0, S1 & AK-47

### HOW TO SPECIFY

*"Door to be a Pyropanel BR-C Bullet resistant doorset, 50mm thick, installed in a Pyropanel heavy duty frame solidly packed with concrete".*

### Pyropanel Developments Pty Ltd

235 Huntingdale Rd, Oakleigh, Vic 3166  
 Ph: (03) 9837 8500 Fax: (03) 9837 8550  
 Email: [sales@pyropanel.com.au](mailto:sales@pyropanel.com.au)  
 Web: [www.pyropanel.com.au](http://www.pyropanel.com.au)

### Distributed by:

### Holland Fire Doors & Windows

23 Saggart Field Rd, Minto, NSW, 2566  
 Ph: 9603 8500  
 Email: [sales@hollandfiredoors.com.au](mailto:sales@hollandfiredoors.com.au)