

# FIRE DOOR LEAVES

## Glass sliding fire doors

**TECH SHEET:** FD-09

Issue: 01-12-06

**Automatic glass sliding fire door incorporating Pyropanel-Forster metal framing system, -/30/- FRL.**

### DESCRIPTION

Fully glazed automatic sliding fire door available as single or bi-parting configurations, incorporating the Pyropanel-Forster insulated steel framing system, Pilkington Pyrostop intumescent fire rated glass, and a Kaba fire rated door operator.

### APPLICATIONS

Ideal for applications that require an automatic glass sliding fire door, but which also require the protection of a fully certified fire door. Especially suitable for in residential complexes, hospitals, schools, shopping centres, shops, offices, public buildings, luxury residential high rise developments, etc.

### FEATURES

- Fully certified to Australian Standards.
- -/30/- FRL.
- Suitable for use in most wall types, including the Pyropanel -/60/- glass wall system which uses Pyropanel-Forster steel framing system and Pilkington Pyrodur fire rated glazing.
- 65mm x 70mm slim line profile.
- Extra large doors available.
- Incorporates 18mm Pilkington Pyrostop Fire rated glass with A-class impact resistance.
- Comes standard with intumescent perimeter smoke / fire seals.
- Single and bi-parting leaf configurations.
- Leaves weigh approx 55kg/m2.
- Utilises the KABA Gilgen KGSSLMVSB door mechanism.

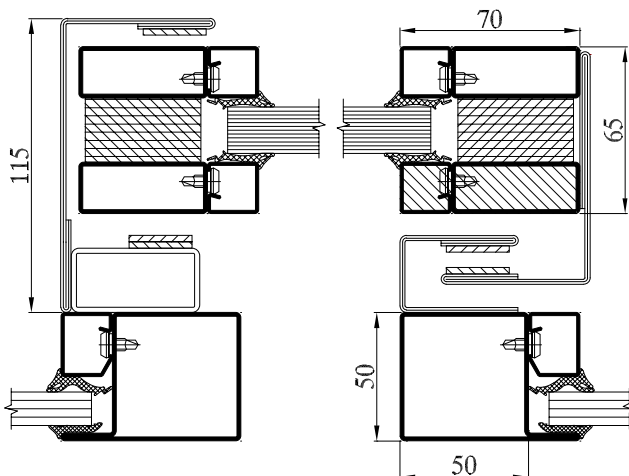

### OPTIONAL EXTRAS

- Powder coating.
- Stainless steel frame.
- -/60/- or -/30/- surrounding side lites.
- Opaque film and decals to glass.

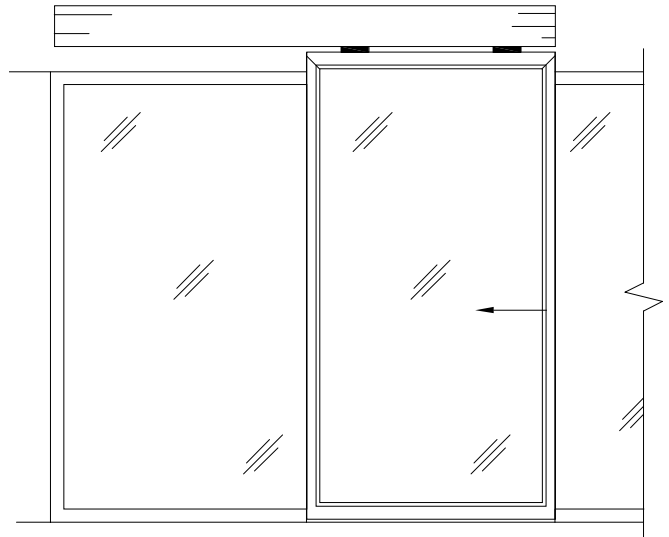

Typical layout of -/30/- single fire rated glass sliding door with -/60/- side lites

### MODELS AVAILABLE

Model	FRL	Thick-ness	Max Leaf size - Single	Max Leaf size - Pair
PGSD30S	-/30/-	65mm	2700mm high x 1405mm wide	NA
PGSD30P	-/30/-	65mm	N/A	2700mm high x 1400mm / 1400mm wide

### HOW TO SPECIFY

Eg, "Door to be a Pyropanel PGSD30S fully glazed single automatic glass sliding fire door, 65mm thick profile, -/30/- FRL, incorporating 18mm Pilkington Pyrostop fire rated glass, complete with flame guards, prime painted/ powdercoat / stainless steel\* finish, incorporating a Kaba KGSSLMVSB certified fire rated operating mechanism, etc"

\* denotes example - delete or change or specify as required



**Pyropanel Developments** Pty Ltd  
 122-124 Beresford Rd, Lilydale, VIC, 3140  
 Ph: (03) 9735 5688 Fax: (03) 9739 5772  
 Email: sales@pyropanel.com.au  
 Web: www.pyropanel.com.au

**Distributed by:**  
**Holland Fire Doors & Windows**  
 23 Saggart Field Rd, Minto, NSW, 2566  
 Ph: 9603 8500  
 Email: sales@hollandfiredoors.com.au