

# 60 minute Fire rated, 30 Rw, Pair Acoustic / Smoke / Fire door

## DESCRIPTION

Pyropanel AP-30-PAN-E is a 30 Rw 48mm nom. acoustic pair door set that utilises a Pyropanel Euroseal® concealed perimeter seal, and a Pyropanel J-section meeting stile (with fin seals) and an approved bottom seal.

## APPLICATIONS

Ideal for anywhere that requires an acoustic rating of 30 Rw and 1hr fire resistance in a pair configuration.

## FEATURES

### Acoustic Rating

- 30 Rw.

### Fire Resistance

- -/60/30

### Smoke Resistance

- Meets the NCC requirement for a smoke door.

### Door Configuration

- Single-acting, pair configuration, hung in a steel or timber frame.

### Perimeter Seal

- Pyropanel Euroseal® concealed smoke / acoustic seal.

### Bottom Seal

- See seal combinations listed on page 2.

### Meeting Stile

- Pyropanel J-section meeting stile (fin seals to each astragal)

### Thickness

- 48mm (Nominal)

### Size

- Maximum Size (overall) - 2420mm high x 1020/1020mm wide.

### Frame

- Pyropanel KDHW Timber or Packed Steel Euroseal frame.

### Finish

- MDF as standard.

## OPTIONAL EXTRAS

- Pre-hung in steel or timber frame.
- Ply, Veneer, Steel or Laminate facings.
- Vision panels - 300 x 200 or 600 x 100mm nom.
- Kick Panels of 1mm Stainless Steel to selected height.

## INSTALLATION

Door frame must be tightly sealed against wall structure using Pyropanel Multiflex fire and acoustic sealant. Steel door frames require packing with Pyropanel FR board, Fire rated plasterboard, Pyropanel M4 light-weight Mortar, concrete or mortar or to achieve desired acoustic rating.

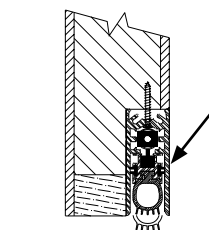
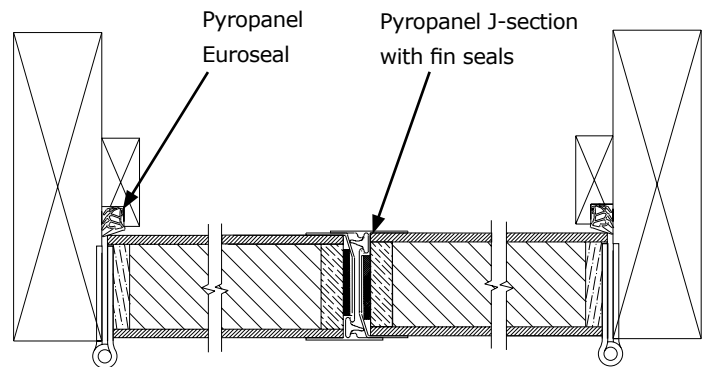

Bottom seal - e.g Raven RP99si (example only, see complete list of bottom seals on page 2)

## HOW TO SPECIFY

"Door to be a Pyropanel AP-30-PAN-E acoustic pair door, with -/60/30\* FRL, installed into a Pyropanel Fire rated timber / packed steel\* Euroseal door frame, with Pyropanel Euroseal, Pyropanel J-section meeting stile (with fin seals) and Raven RP99si\* bottom seals".

\* denotes example - delete, change or specify as required

## Pyropanel Developments Pty Ltd

Unit 1, 97 Lewis Rd, Wantirna South, Vic 3152

Ph: (03) 9837 8500 Fax: (03) 9837 8550

Email: [sales@pyropanel.com.au](mailto:sales@pyropanel.com.au)

Web: [www.pyropanel.com.au](http://www.pyropanel.com.au)

Pyropanel Developments has a policy of continuous improvement and reserves the right to change methods and specifications without notice.  
 Note: The Tech Sheet is an uncontrolled document, If printed please refer to the Tech-Sheet on the website to check if this document is valid.

## Distributed by:

### Holland Fire Doors & Windows

23 Saggart Field Rd, Minto, NSW, 2566

Ph: 9603 8500

Email: [sales@hollandfiredoors.com.au](mailto:sales@hollandfiredoors.com.au)

**ASSA ABLOY****ACOUSTIC DOOR**

60 minute Fire rated, 30 Rw, Pair Acoustic / Smoke / Fire door

**SEAL COMBINATIONS**

Door Type	Perimeter Seals	Bottom Seals
AP-30-PAN-E	Pyropanel Euroseal	Raven RP99si
		Raven RP38si
		Raven RP35si
		Raven RP8si
		Lorient LAS8001si
		Lorient LAS8002si
		Lorient LAS8003si
		Lorient LAS8005si
		Lorient LAS8006si
		Lorient LAS8007si
		Lorient LAS8008si
		Lorient LAS8009si

**Pyropanel Developments Pty Ltd**

Unit 1, 97 Lewis Rd, Wantirna South, Vic 3152

Ph: **(03) 9837 8500** Fax: (03) 9837 8550Email: [sales@pyropanel.com.au](mailto:sales@pyropanel.com.au)Web: [www.pyropanel.com.au](http://www.pyropanel.com.au)**Distributed by:****Holland Fire Doors & Windows**

23 Saggart Field Rd, Minto, NSW, 2566

Ph: **9603 8500**Email: [sales@hollandfiredoors.com.au](mailto:sales@hollandfiredoors.com.au)