

# ACOUSTIC DOOR

## Acoustic (37 Rw) / Smoke Door (non-fire rated)

### DESCRIPTION

Pyropanel AS-37-PAD is a Single leaf, 37 Rw acoustic and smoke resistant doorset.

### APPLICATIONS

Ideal for applications that require an acoustic rating of 37 Rw and smoke resistance.

### FEATURES

#### Acoustic Rating

- 37 Rw.

#### Door Weight

- Approx 27 kg/m<sup>2</sup>

#### Smoke Resistance

- Meets the NCC requirement for a smoke door.

#### Door Configuration

- Single leaf.

#### Thickness

- 45mm (Nominal)

#### Size

- Maximum Size - 2340 x 1020mm.

#### Hinges

- Minimum 4 steel hinges.

#### Frame

- Packed steel frame (1.2 or 1.6mm), or KDHW timber frame.

#### Finish

- MDF to both faces.

Door Type	Perimeter	Bottom	Rw
AS-37-PAD	Pyropanel Euroseal	Pyropanel PY-BS1	37

### OPTIONAL EXTRAS

- Pre-hung in steel or timber frame.
- Decorative veneers.
- Steel faces.
- Pyropanel Pyrodur 13mm thick Vision panels - 300 x 200 or 600 x 100mm.

### INSTALLATION

Door frame, Perimeter seal, Drop seal & Door leaf should be sourced from a Pyropanel Authorised Licensee as a complete set. Door frame must be tightly sealed against wall structure using Pyropanel Multiflex acoustic sealant. Steel frames require packing with Pyropanel FR board or Pyropanel light weight M4 Mortar to achieve the acoustic rating.

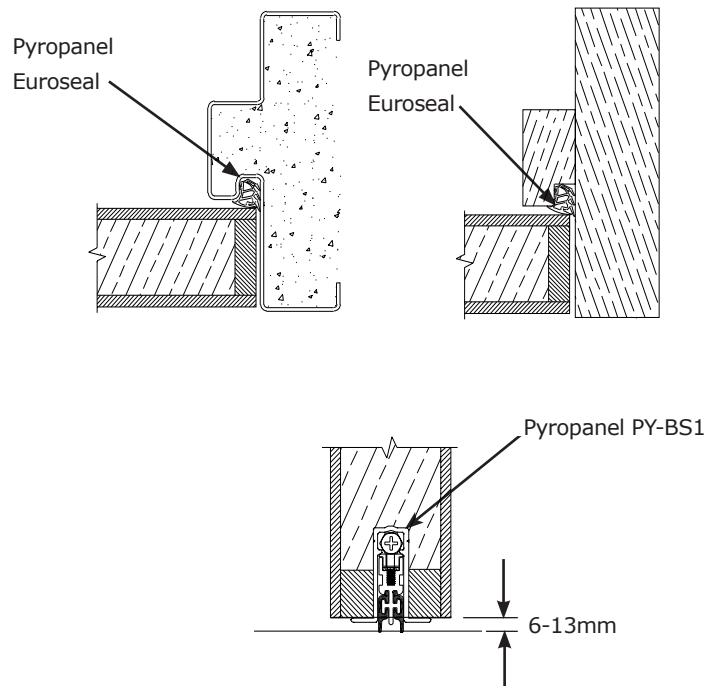

### HOW TO SPECIFY

"Doorset to be a Pyropanel AS-37-PAD acoustic door installed into a steel/timber\* Euroseal frame".

\* denotes example - delete, change or specify as required

#### Pyropanel Developments Pty Ltd

235 Huntingdale Road, Oakleigh Vic 3166  
 Ph: **(03) 9837 8500** Fax: (03) 9837 8550  
 Email: [sales@pyropanel.com.au](mailto:sales@pyropanel.com.au)  
 Web: [www.pyropanel.com.au](http://www.pyropanel.com.au)

#### Distributed by:

#### Holland Fire Doors & Windows

23 Saggart Field Rd, Minto, NSW, 2566  
 Ph: **9603 8500**  
 Email: [sales@hollandfiredoors.com.au](mailto:sales@hollandfiredoors.com.au)